

12Volt 200Ah

Specifications

Nominal Voltage(V) **12V**

Nominal Capacity

10 hour rate	(20A	to	10.80V)	200Ah
5 hour rate	(34A	to	10.20V)	170Ah
1 hour rate	(120A	to	9.60V)	120Ah

Weight **Approx. 68.5kg(151Lbs.)**

Internal Resistance (at 1KHz) **Approx. 3.5 mΩ**

Maximum Discharge Current for 5 seconds: **1600A**

Charging Methods at 25 (77)

Cycle use:

Charging Voltage **14.4 to 15.0V**

Coefficient -5.0mv/ /cell

Maximum Charging Current : **60A**

Standby use:

Float Charging Voltage **13.50 to 13.80V**

Coefficient -3.0mv/ /cell

Operating Temperature Range

Charge **-15 (5) to 40 (104)**

Discharge **-15 (5) to 50 (122)**

Storage **-15 (5) to 40 (104)**

Charge Retention (shelf life) at 20 (68)

1 month **98%**

3 month **94%**

6 month **85%**

Case Material **ABS**

(UL94-V0 flame retardant case / cover)

Terminal **F18**

Description of torque value of hard ware for the terminals:

Recommended torque value **M8: 7.35 N-m (75kg-cm)**

Maximum allowable torque value **M8: 9.8 N-m (100kg-cm)**



Dimensions

mm(inch)

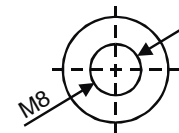

(M8 Bolt)
F18

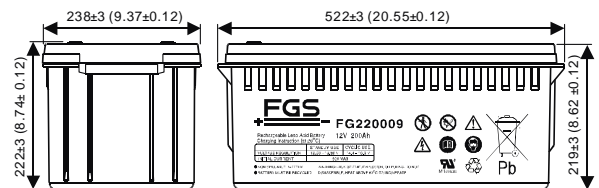
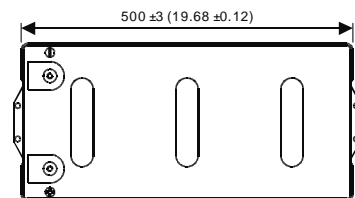

(V) FOR 12V BATTERY **Discharge Time VS. Discharge Current (25)**

